

双高清网络摄像机

Dual-HD Wireless IP Camera

家庭使用 商店使用 室内使用



简易操作手册 >>>

更多资料, 请登陆在线光盘资料网站
<http://www.cam158.com>

快速入门指南

1. 下载并安装应用程序
 - A. 确保你的移动设备能正确地连接到网络。
 - B. 在Google Play或App Store中搜索和下载“BlueCam”。



2. 检查无线网络环境启用路由器的DHCP功能, 并确保它在2.4 GHz下工作。(5GHz不受设备的支持)确保您的智能手机连接到路由器。

3. 连接设备

方法 1: 无线连接(以下连接方法适用于YT系列, KP系列, QJ系列, WJ系列, ML系列机型)

- A. 请将设备插上电源, 然后等待设备发出, “欢迎使用, 请连接网络”。(如果您没有听到提示音, 请按重置按钮重置设备)
 - B. 添加设备(以Android手机为例)
 - 第一步: 启动应用程序, 点击“+”(图1);
 - 第二步: 点击“无线配置”(图2);
 - 第三步: 点击“已经听到语音提示”(图3);
 - 第四步: 输入无线网络密码, 然后点击“连接WiFi”(图4);
 - 第五步: 点击“开始配置”, 并等待30S。(图5);
 - 第六步: 在对码完成界面, 找到要添加的设备并点击“添加按钮”(图6);
 - 第七步: 在设备列表页面能看到已经添加的设备, 设备显示在线(图7);
 - 第八步: 点击播放按钮, 会弹出安全提示, 此时点击确定, 进入用户设置页面(图8);
 - 第九步: 在用户设备页面修改用户名和密码后, 点击完成按钮, 开始进行实时查看(图9);
- 注意: 我们强烈建议您设置一个强大的用户名和密码来保护您的隐私。

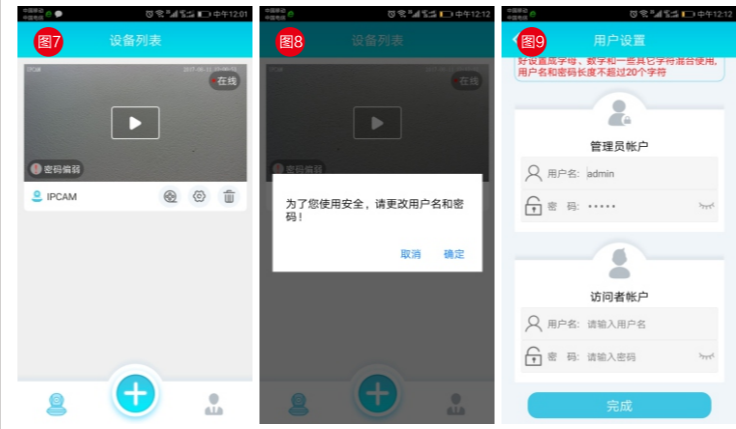
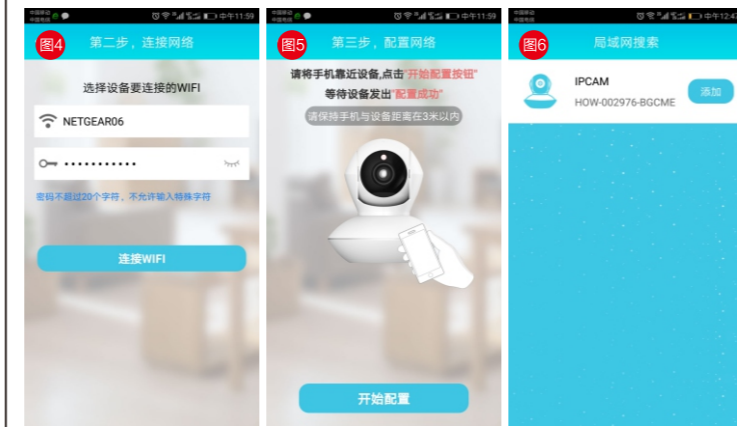

如果对码成功页面没有设备出现, 请回到第二步并重新配置设备。重置按钮: 长按“重置”按钮5秒, 设备将重新启动(您可以听到“复位成功”声音), 它会自动恢复到出厂设置。所以您必须在重新启动后再做一次wifi设置。

注意: 当您试图重置设备时, 请确保它是电源开启的。

方法2: AP(热点)连接(以下连接方式适用于QJ系列, WJ系列产品)
 第1步: 打开手机设置, 选择WLAN设置, 搜索无线网络摄像机ID, wifi摄像机ID前缀为: HOW-XX(图1);
 第2步: 单击ID, 密码: 168168168, 完成WLAN连接(图2);
 第3步: 启动应用“BlueCam”, 点击“+”(图3);
 第4步: 点击“局域网搜索”进入局域网搜索页面(图4);
 第5步: 在局域网搜索页面, 找到要添加的设备, 然后点击添加按钮(图5);
 第6步: 在设备列表页面能看到已经添加的设备, 设备显示在线(图6);
 第7步: 点击播放按钮, 会弹出安全提示, 此时点击确定, 进入用户设置页面(图7);
 第8步: 在用户设备页面修改用户名和密码后, 点击完成按钮, 开始进行实时查看(图8);
 注意: 我们强烈建议您设置一个强大的用户名和密码来保护您的隐私。
 第9步: 在设备列表页面, 请点击设置按钮(图9);
 第10步: 点击“WiFi设置”(图10);
 第11步: 选择要连接的网络并输入密码, 然后点击设置按钮摄像机将重新启动并自动连接到wifi网络(图11);
 注意: 重启的时候设备不要断电

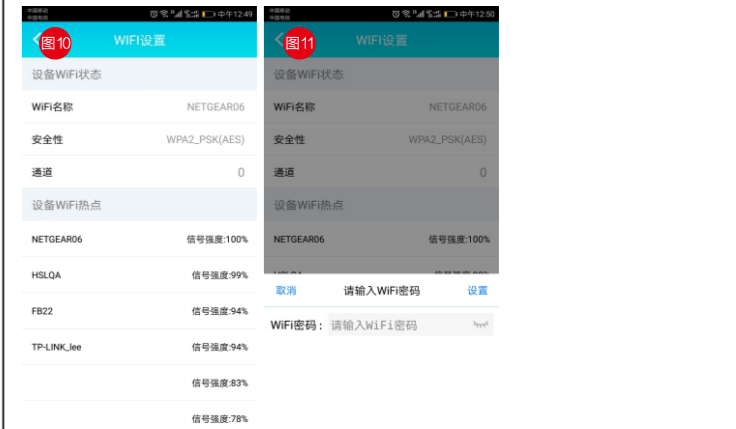
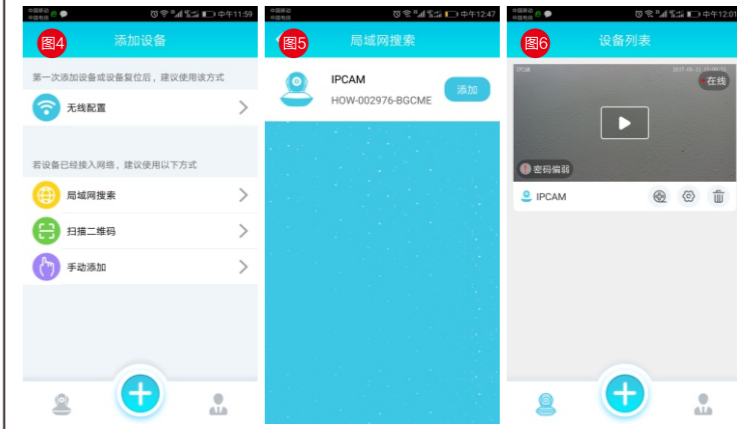
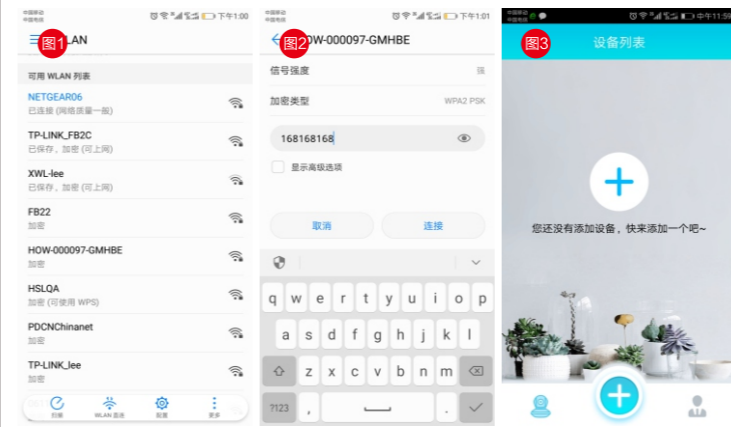

4. 查看这些视频, 我们将以智能手机为例。

Dual-HD Wireless IP Camera

Family use Stores use Indoor use



Quick User Guide >>>

For more information, please visit our online website
<http://www.cam158.com>

Quick start guide

1. Download and install the application
 - A. Make sure your mobile device is properly connected to the network.
 - B. Search and download “BlueCam” in Google Play or the App Store.



2. Check the wireless network environment
 Enable the router's DHCP functionality and ensure that it works under 2.4ghz.(5GHz is not supported by Device)Make sure your smartphone is connected to your router.

3. Connect device

Method 1: wireless connection (the connection method is suitable for YT series, KP series, QJ series, WJ series, ML series models)

- A. Power On the IP camera, the device will start from the voice prompt, "welcome to use, please connect the network". (if you don't hear the voice prompt, press the reset button to restart the device)
 - B. Add devices (for Android phones)
 - Step 1: start the application and click "+" (figure 1);
 - Step 2: click "wireless configuration" (figure 2);
 - Step 3: click "already heard the voice prompt" (figure 3);
 - Step 4: enter the wireless password and then click "connect WIFI" (figure 4);
 - Step 5: click "start" and wait for 30S.(figure 5);
 - Step 6: On the code completion interface, find the device to add and click the add button (figure 6).
 - Step 7: Find the device already added on the device list page, and the device is displayed online (figure 7);
 - Step 8: click the play button, the security tips will pop up, and click ok to enter into the user settings page (figure 8).
 - Step 9: modify the user name and password on the user-device page, click finish button to start the real-time view (figure 9).
- Note: A powerful username and password is strongly recommended by us to protect your privacy.

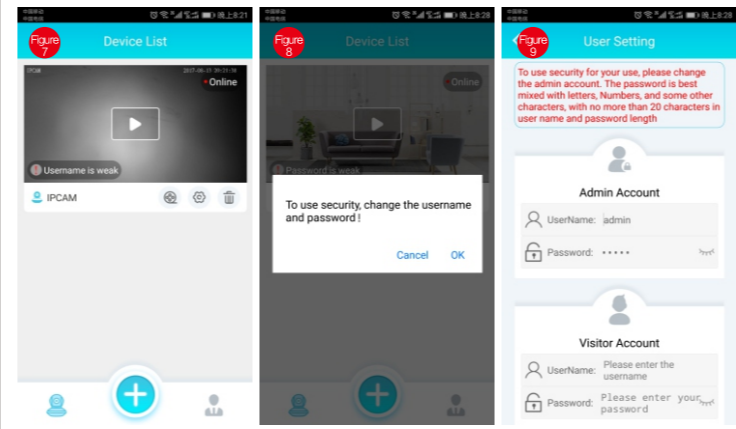
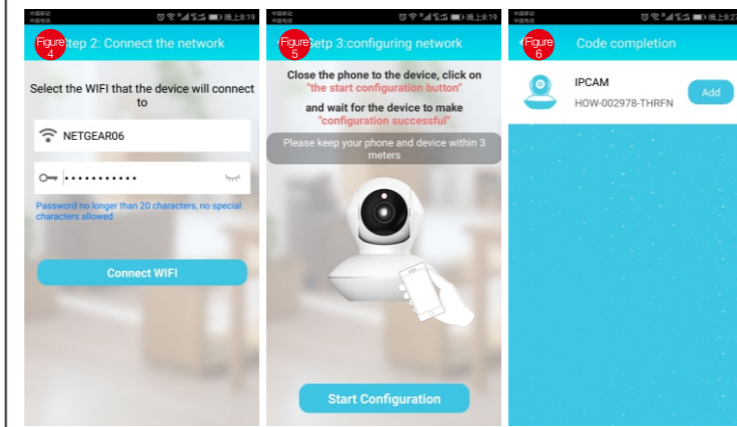
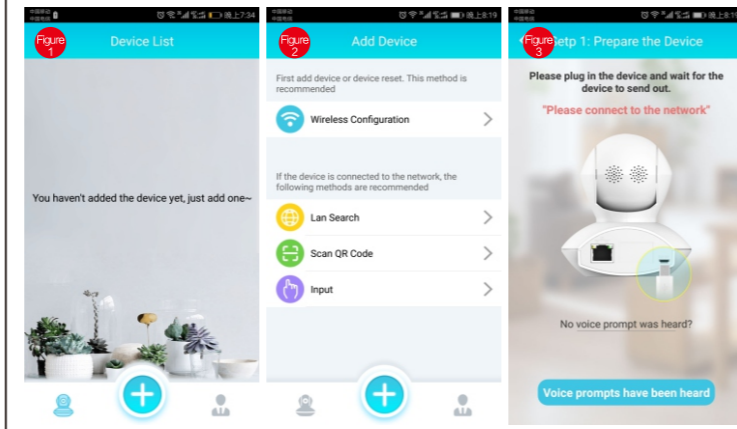

If there is no device on the code success page, go back to step 2 and re-configure the device. Reset button: Press "reset" button for 5 seconds and the device will reboot (you can hear "reset success") and it will automatically revert to factory settings. So you need to make a wifi setup again after reboot.

Note: when you try to reset the device, make sure it is powered on.

Method 2: AP (hotspot) connection (the connection mode is applicable to QJ series, WJ series products)
 Step 1: open the phone Settings, select WLAN Settings, search the wireless webcam ID, and the wifi camera ID prefix is: HOW - etc. (figure 1);
 Step 2: click ID, password: 168168168, complete WLAN connection (figure 2);
 Step 3: Run the application of "BlueCam" and click "+" (figure 3);
 Step 4: click "LAN search" to enter the LAN search page (figure 4);
 Step 5: on the LAN search page, find the device to add, then click the add button (figure 5);
 Step 6: Find the added devices on the device list page, and the device displays online (figure 6);
 Step 7: click the play button to pop up the security tips, and click ok to enter the user settings page (figure 7).
 Step 8: Modify the user name and password on the user-device page, click the finish button to start the real-time view (figure 8);
 Note: we strongly recommend that you set up a powerful username and password to protect your privacy.
 Step 9: on the device list page, click the Settings button (figure 9);
 Step 10: click on "WiFi Settings" (figure 10);
 Step 11: select the network you want to connect to and enter your password, then click the Settings button to restart and automatically connect to the wifi network (figure 11).
 Note: don't power off the device when you reboot.

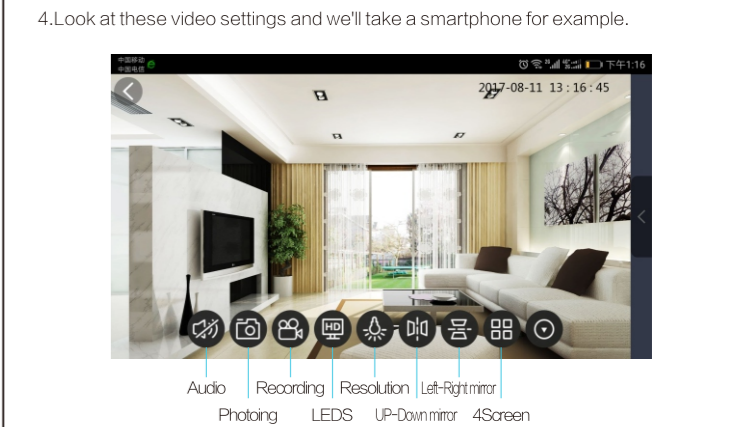
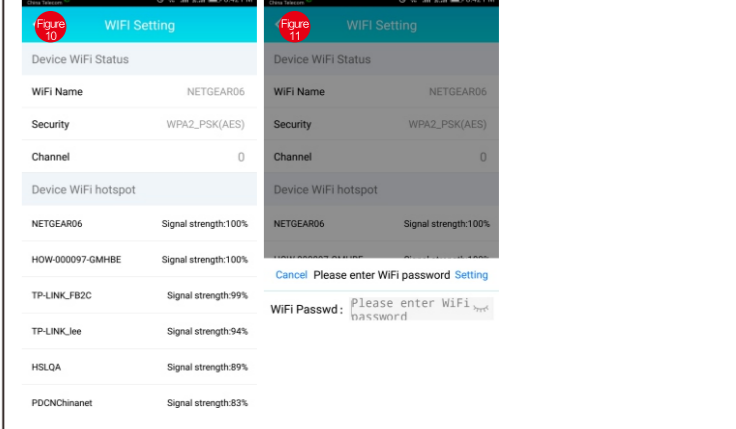
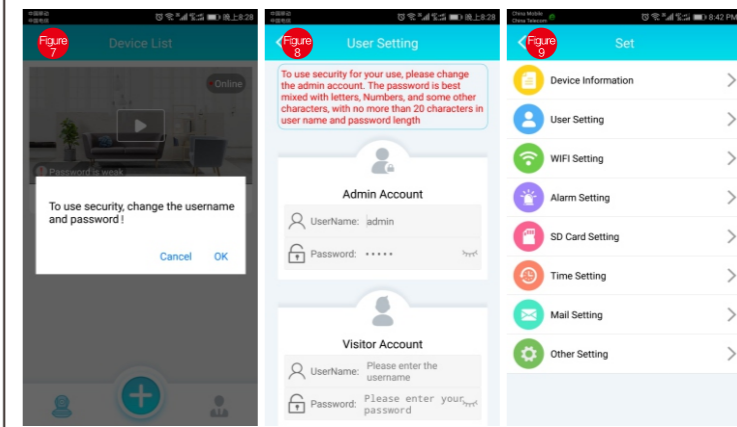
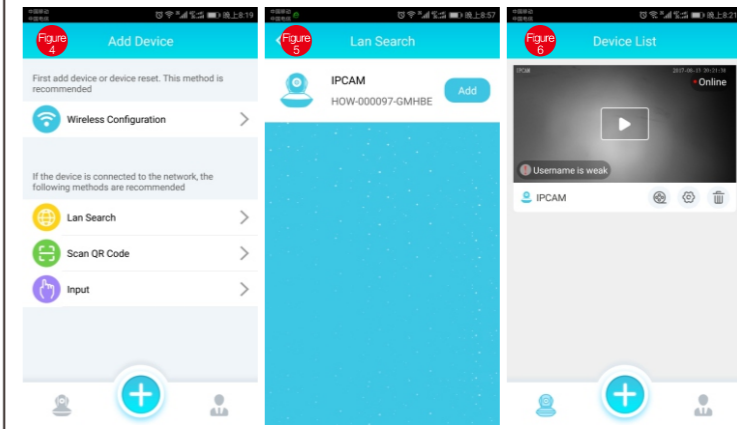
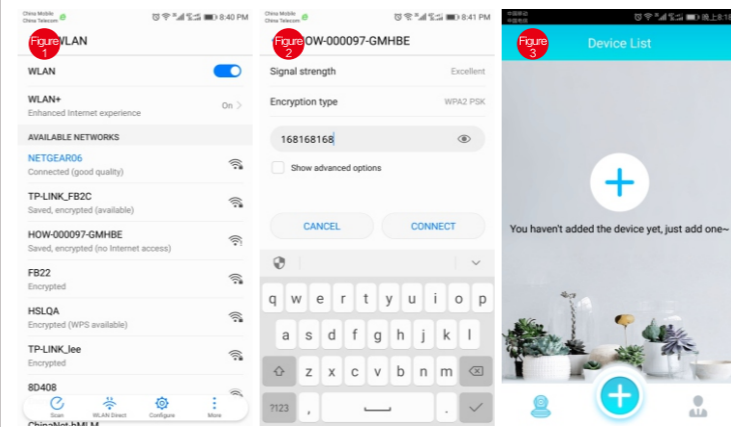

4. Look at these video settings and we'll take a smartphone for example.